

Available to Order

2027 McConaghy Boats MC55

54' (16.70) 2027 McConaghy Boats MC55

Fort Lauderdale United States

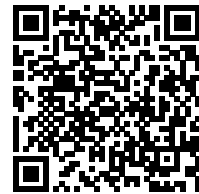

\$3,380,000

OVERVIEW

Manufacturer:	McConaghy Boats	Hull Material:	Composite
Engines:	—	Cruise Speed:	—
Engine Model:	—	Max Speed:	—
Engine HP:	57.00	Cabins / Heads:	—
Beam:	27	Fuel Type:	—
Max Draft:	12	Fuel:	121.52
Water:	121.52		

Data Sheet

Category:	Crew Cabins:	Displacement: 17.22
Subcategory:	Captain's Quarters:	Fuel Tank: 121.52
Condition: New	Crew Sleeps:	Fresh Water: 121.52
Model Year: 2027	Maximum Speed:	Holding Tank:
Beam: 27	Cruise Speed:	Imported:
Max Draft: 12	Range NM:	Builder: McConaghy
LOA: 54	Fuel Type:	Exterior Color:
Cabins:	Hull Material: Composite	HIN / IMO:
Sleeps:	Hull Shape:	In Stock:
Single Berths:	Hull Finish:	
Double Berths:	Factory Demo:	
Queen Berths:	Air Conditioning:	
King Berths:	Bridge Clearance:	
Heads:	Max Passengers:	

Engines / Generators

Engine 1

Engine 2

57.00 HP

Fuel:

Location:

57.00 HP

Fuel:

Location:

Generator 1 KW hrs

Generator 2 KW hrs

Summary / Description

Powerful yet easy to manage under sail, the MC55 is the latest addition to the McConaghy Multihulls range. An extremely luxurious finish comes as standard and enhancements to the aft deck give a larger area for socializing, space for watersports toys, and additional systems.

The MC55 not only benefits from McConaghy's vast experience building performance boats but also from a carefully considered use of carbon, which sees her precise hull forms achieve an optimum strength-to-weight ratio.

As with all McConaghy Multihulls, the MC55 has dual helm positions on the flybridge, allowing for the greatest sight lines forward as well as an elevated position that aids more difficult in-port maneuvers – making her an ideal choice for those new to multihull cruising.

There are two accommodation layouts to choose from; a four-cabin layout (all en suite) or a three-cabin layout, which allows for a large master suite, complete with private study, in the starboard hull.

The wide saloon offers a versatile and spacious living area that, with large windows running the full length of the hulls and fully retractable glass doors aft, is exceptionally light and provides fantastic views. The galley is arranged open-plan to this area, which creates an apartment-like feel and is particularly well suited to socializing and family living.

The MC55's interior styling comes from m2Atelier, an award-winning studio with extensive experience in both large custom yachts and the production sector. Their attention to detail and innovative storage solutions allow living space to be maximized.

VIYB Ltd is pleased to assist you in the purchase of this vessel. This boat is centrally listed by Troyer Yachts. It is offered as a convenience by this broker/dealer to its clients and is not intended to convey direct representation of a particular vessel



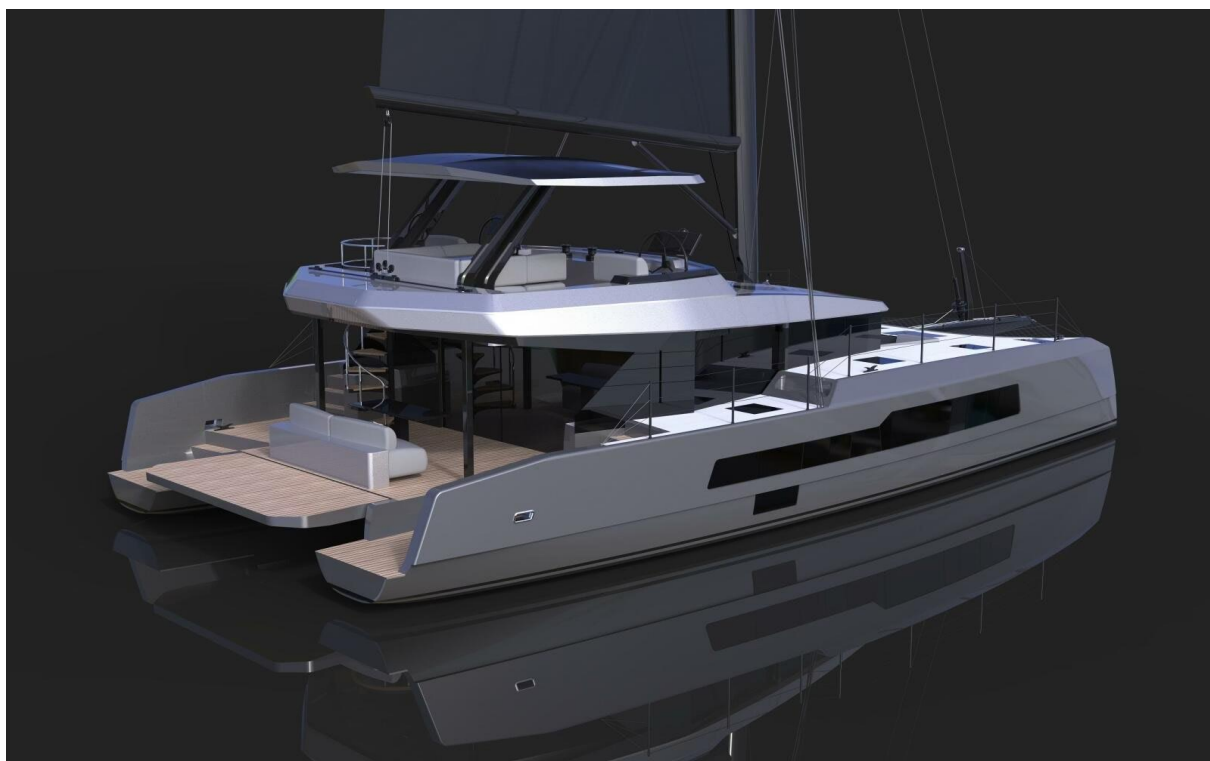

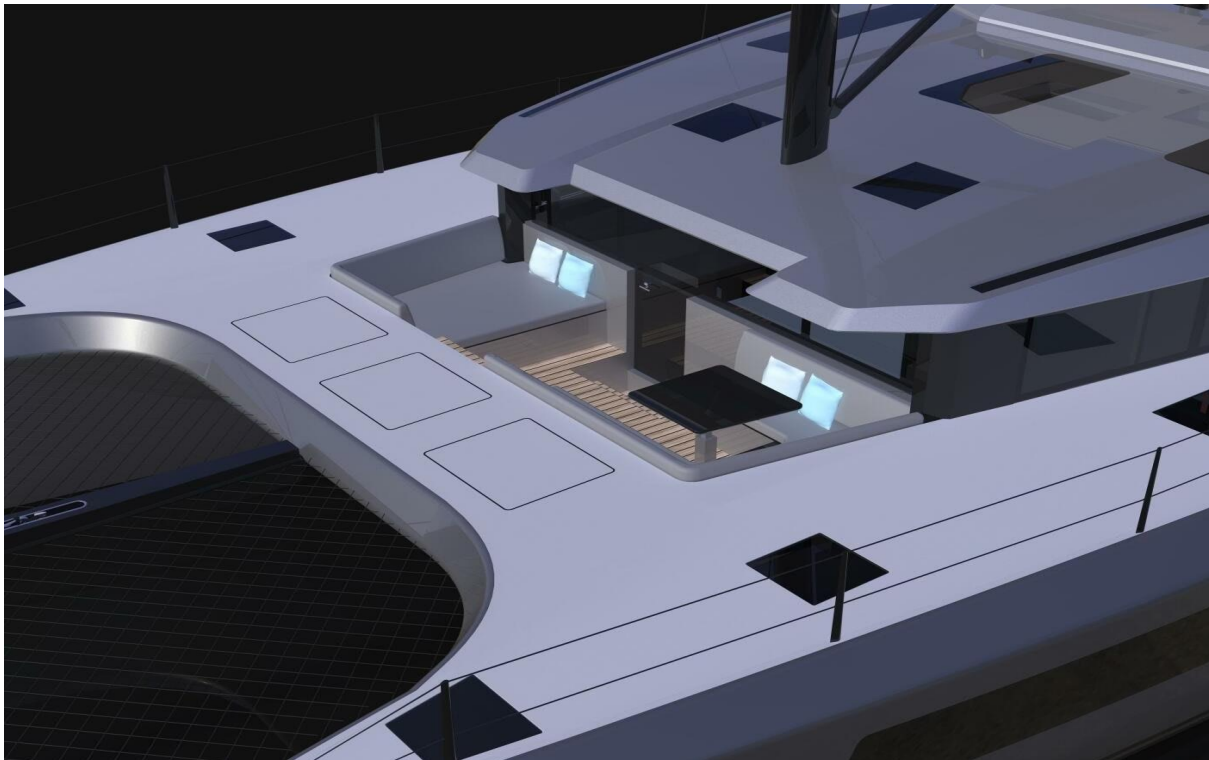

MC55
MULTIHULL

MAIN DECK

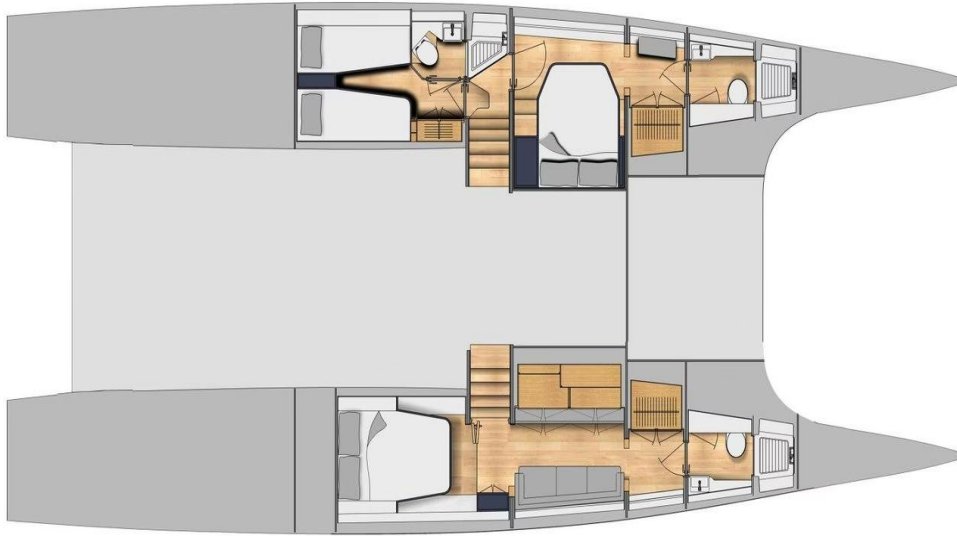

MC55
MULTIHULL

3 CABIN LAYOUT

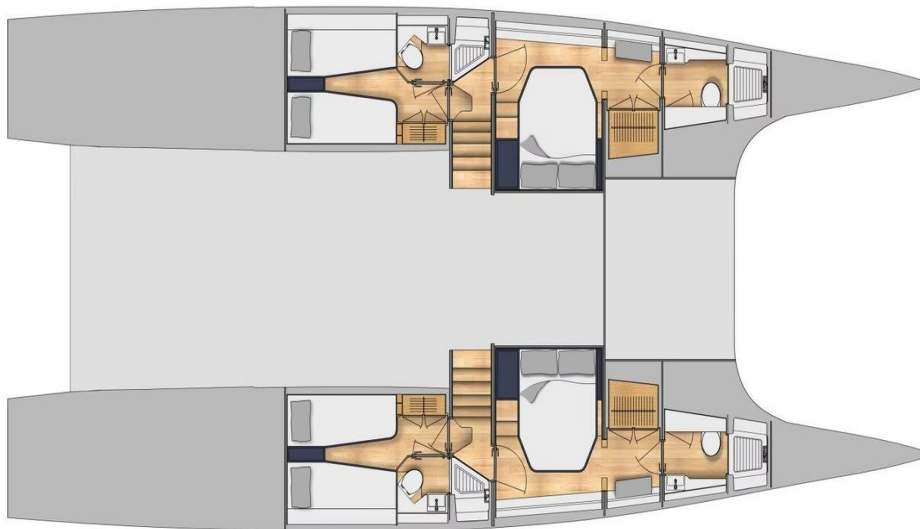

MC55
MULTIHULL

4 CABIN LAYOUT

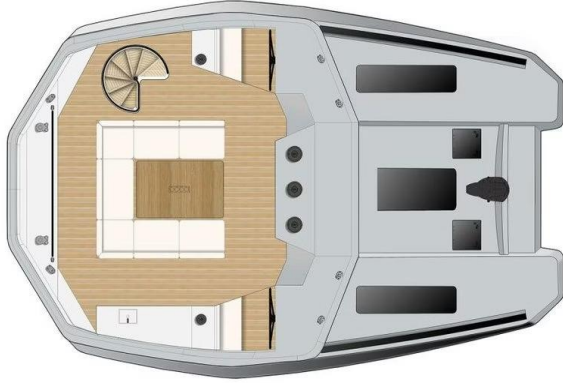

MC55
MULTIHULL

FLYBRIDGE